



## Villa Vuoto

Gestured Form and Activated Space

Osher at CMU 2024.04.10



# Villa Vuoto

Case Study





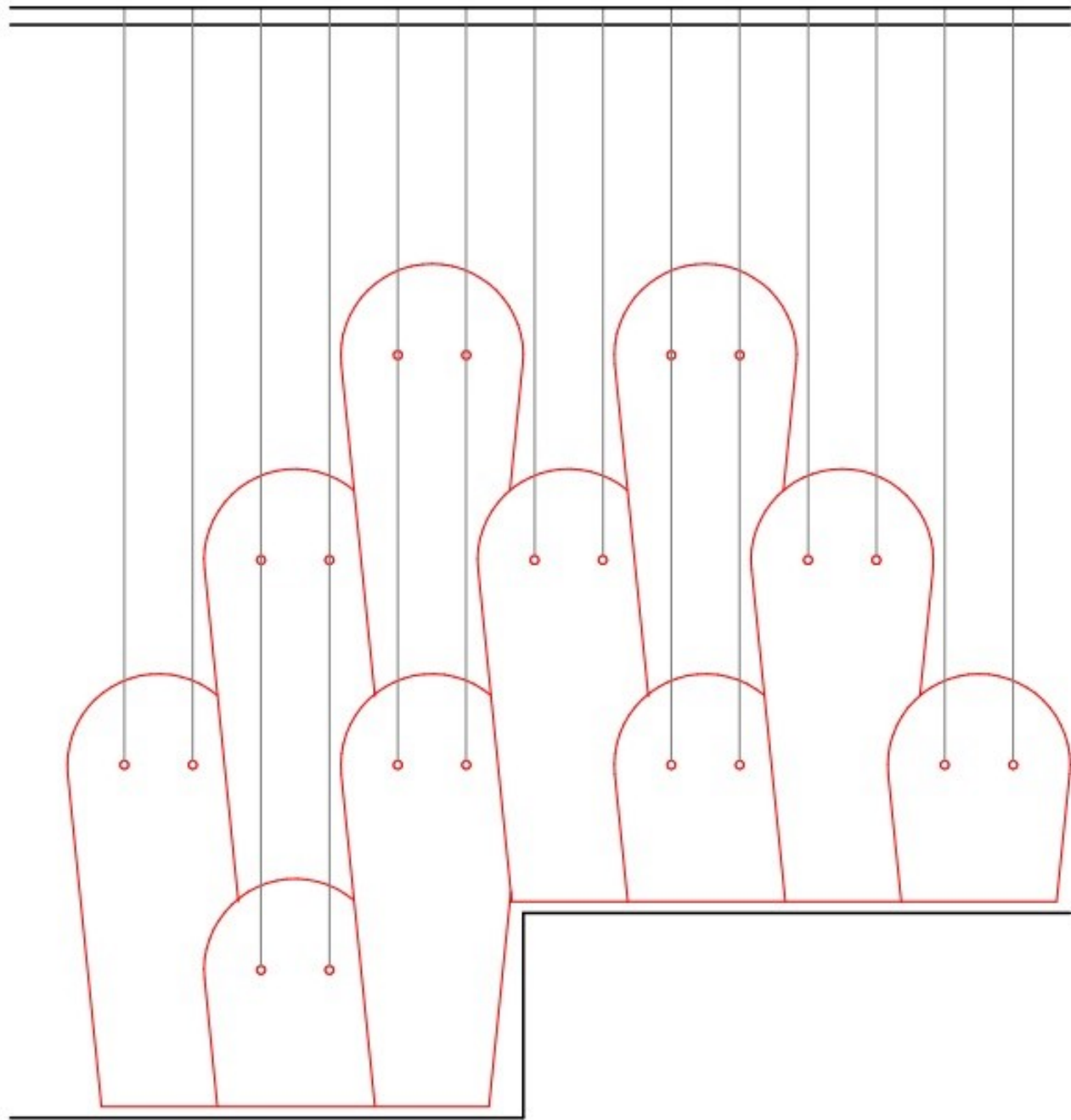

(2) 5/8" DIA. HOLES  
AT 6" APART

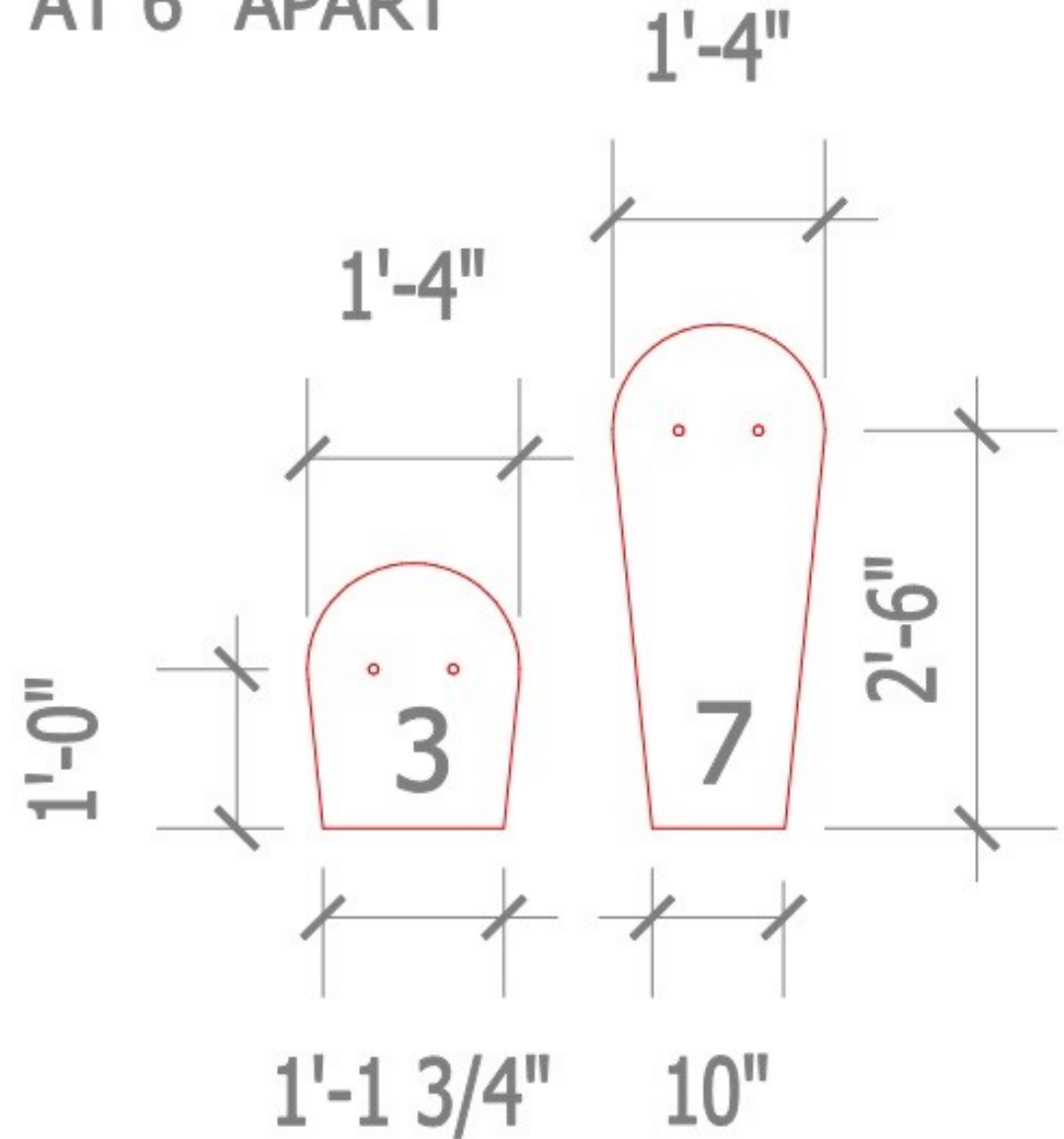







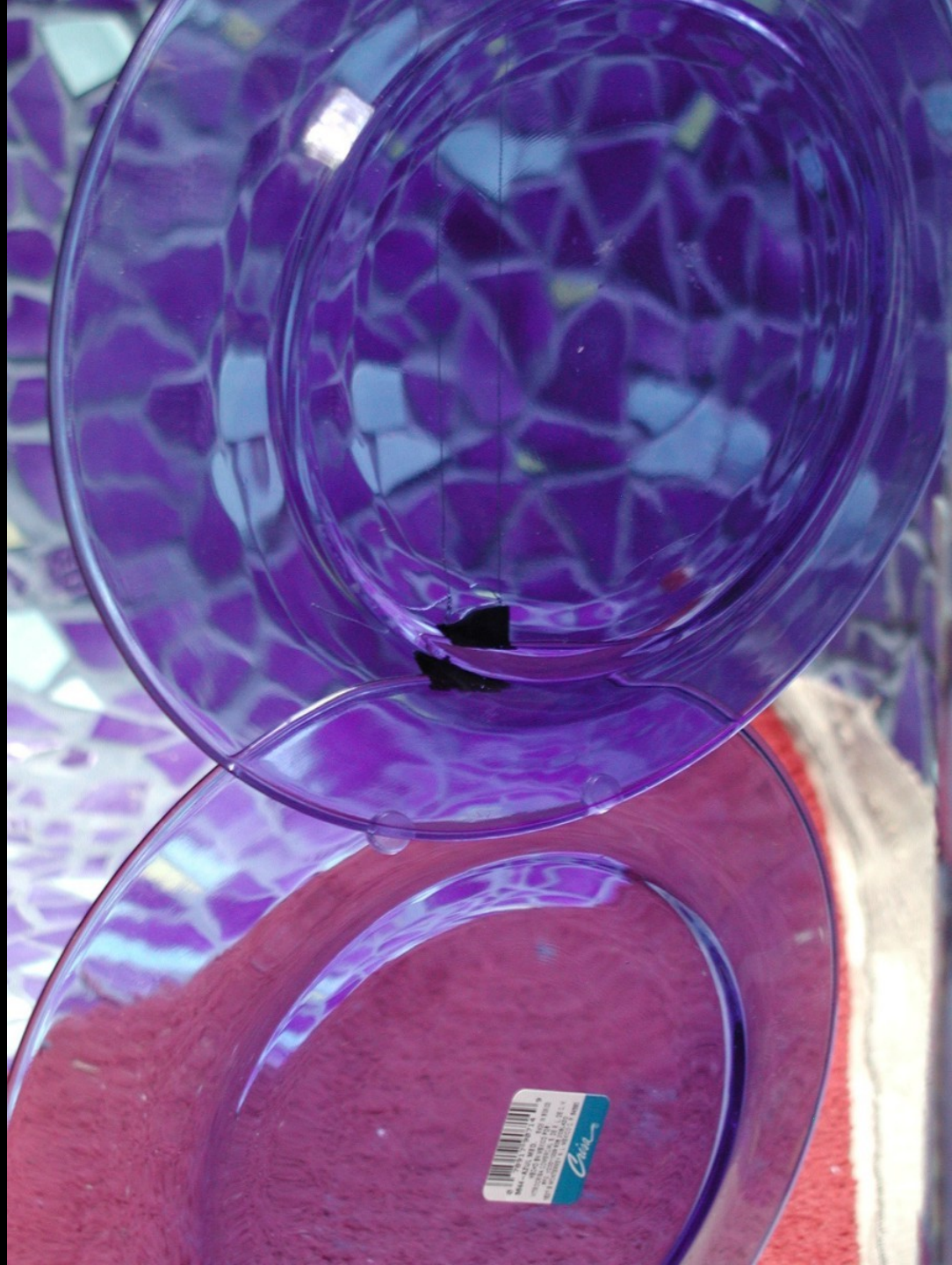



















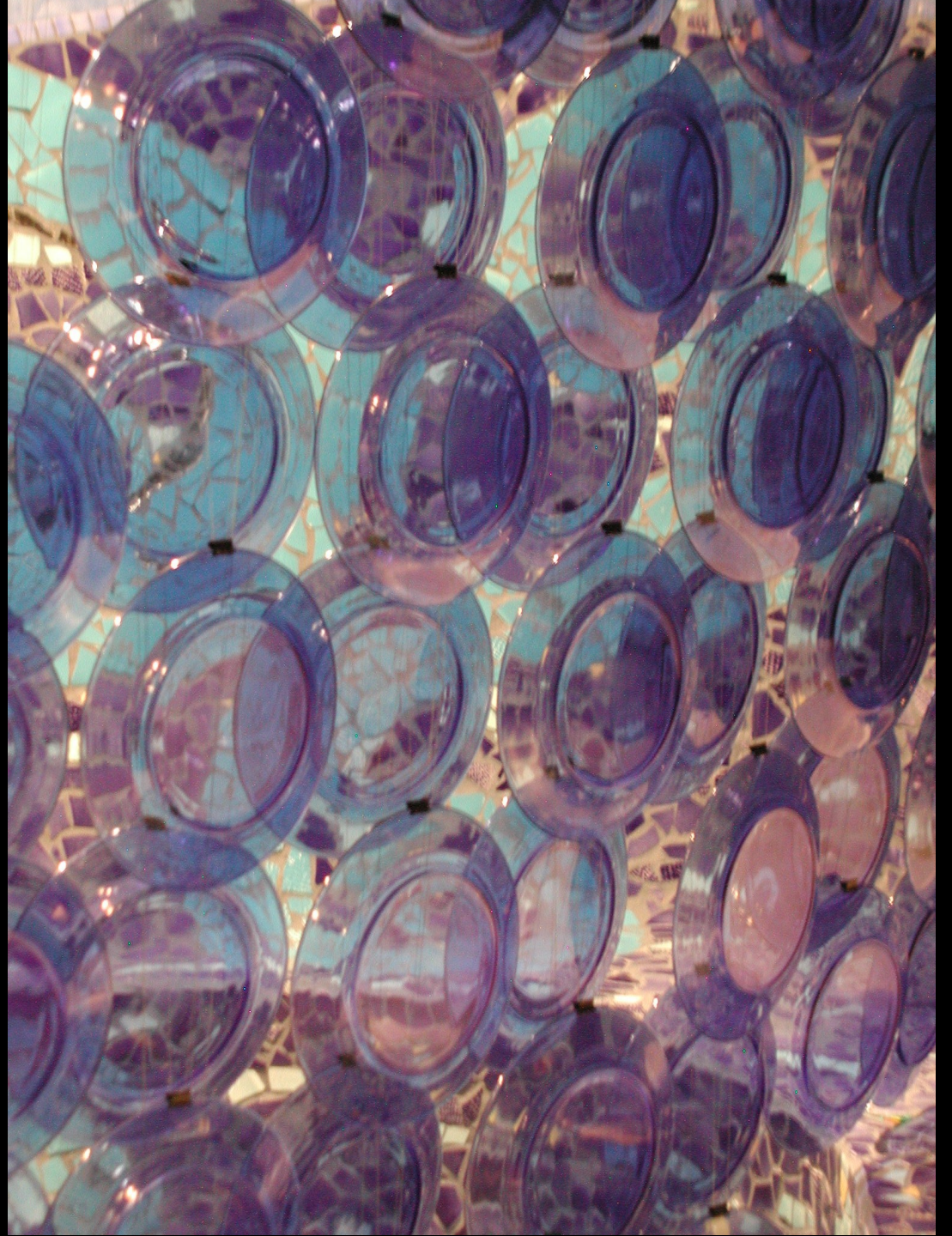



















LOCAL STAMP LEGACY PUTS BHUTAN ON THE MAP



# Pittsburgh

MAGAZINE  
pittsburghmagazine.com

March 2008

WINNER!  
RESIDENTIAL SPACE  
UNDER \$25,000

*This master bathroom in Wexford is seen through one of the room's wood circle windows. The space is reminiscent of the Blue Grotto on the Island of Capri in Italy.*

# Far out

Tour the winning homes from our 14th Annual

**SUPERIOR INTERIORS CONTEST**





A close-up shot of a white ceramic bathroom sink with a waterfall-style chrome faucet. The sink is set on a countertop with a mosaic of light blue, white, and yellow tiles. In the background, a lit candle in a glass holder and some greenery are visible, creating a warm, ambient atmosphere.

ALL NEW EPISODE  
**BUYING  
THE BAYOU**  
TONIGHT 10/9c

**DESTINATION  
AMERICA**











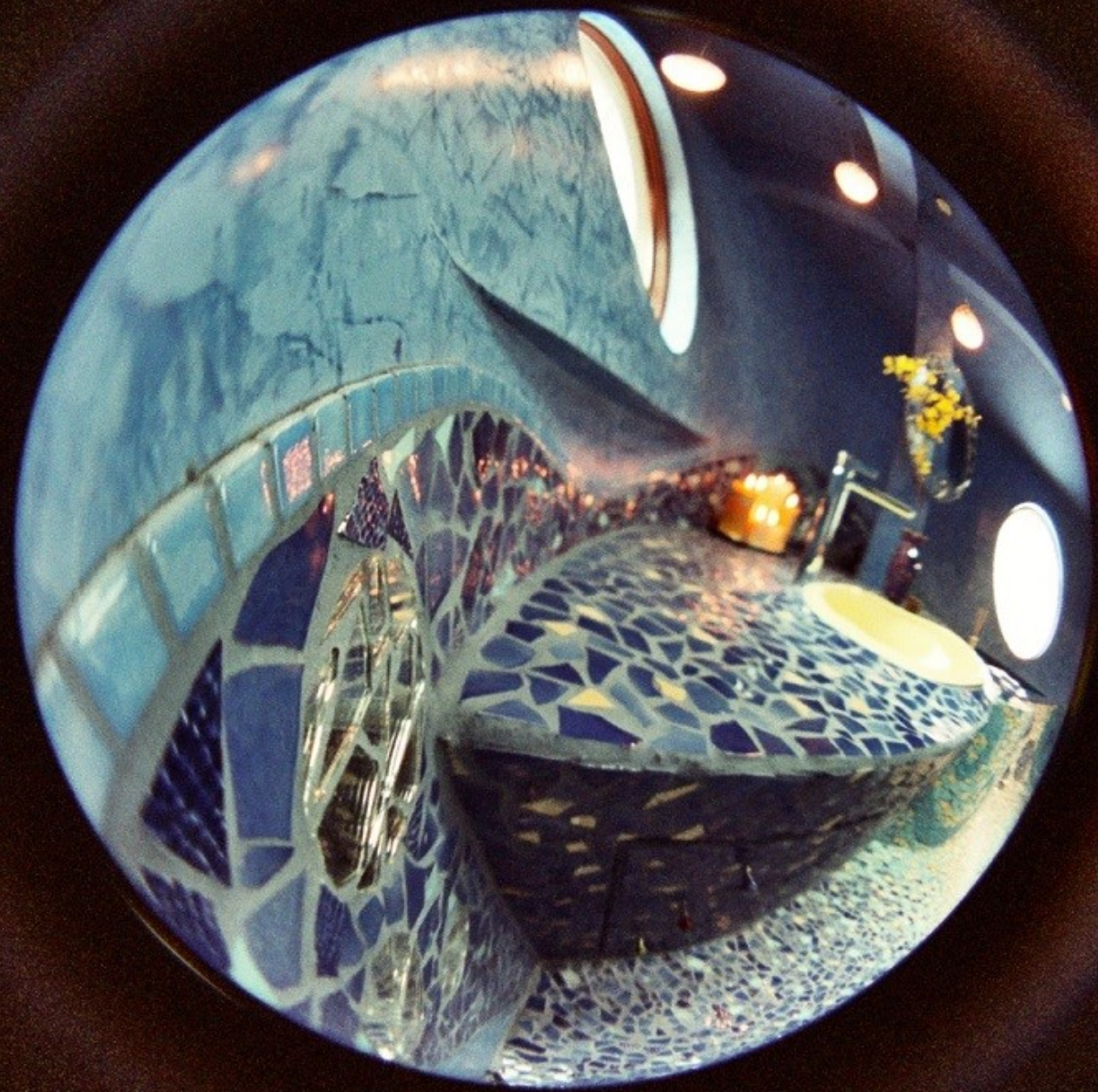



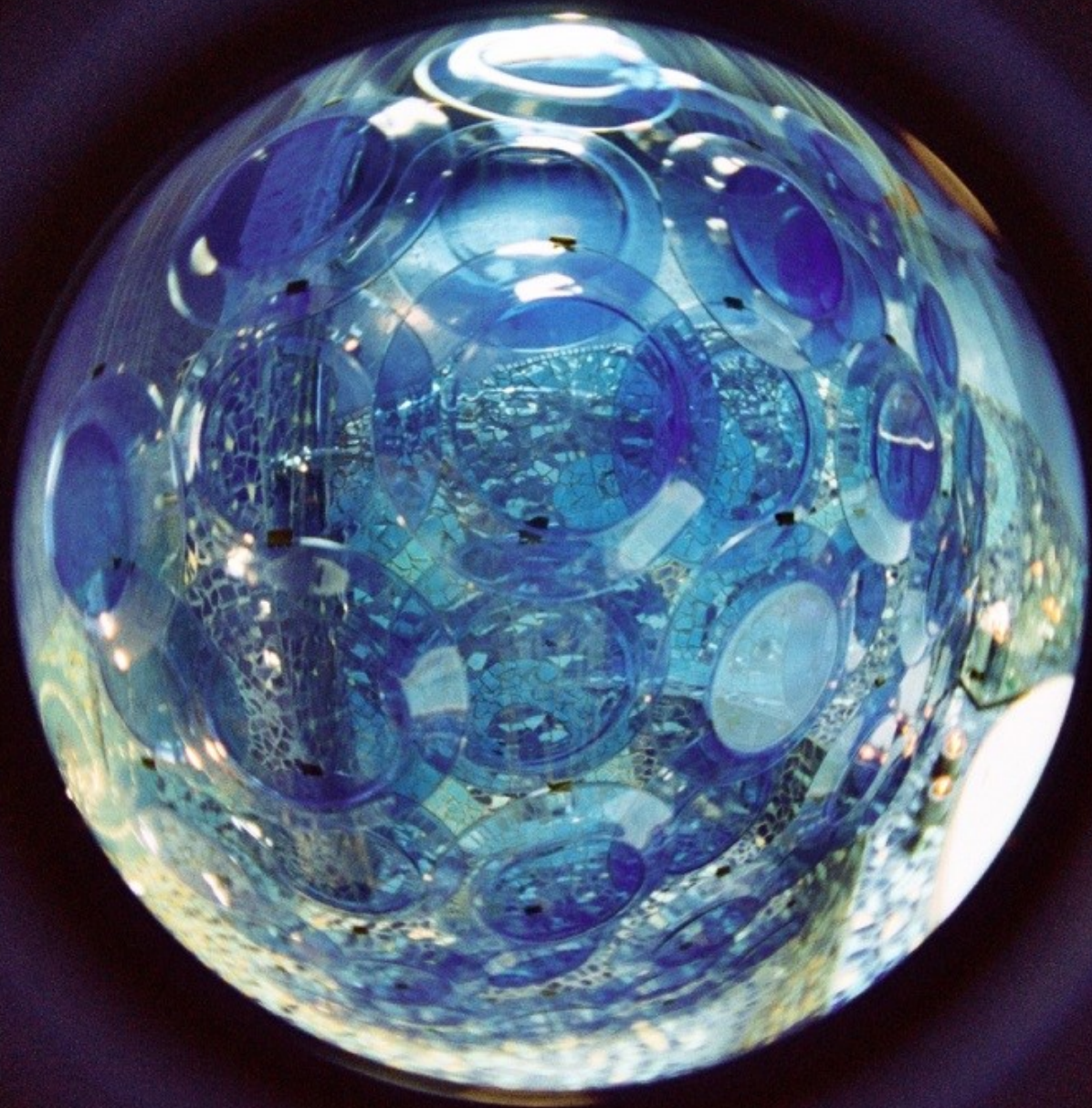

























TILE





























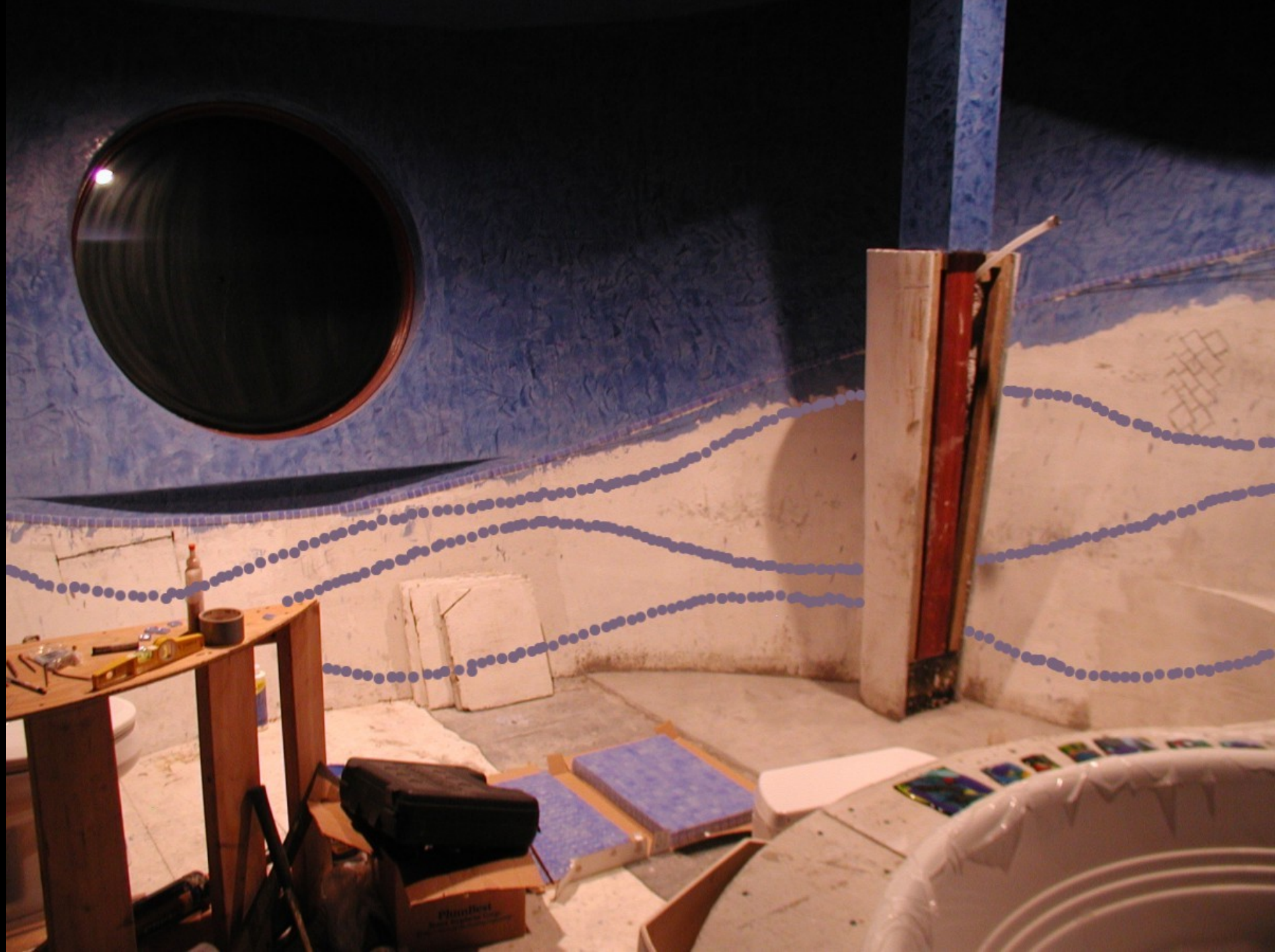



















































































































































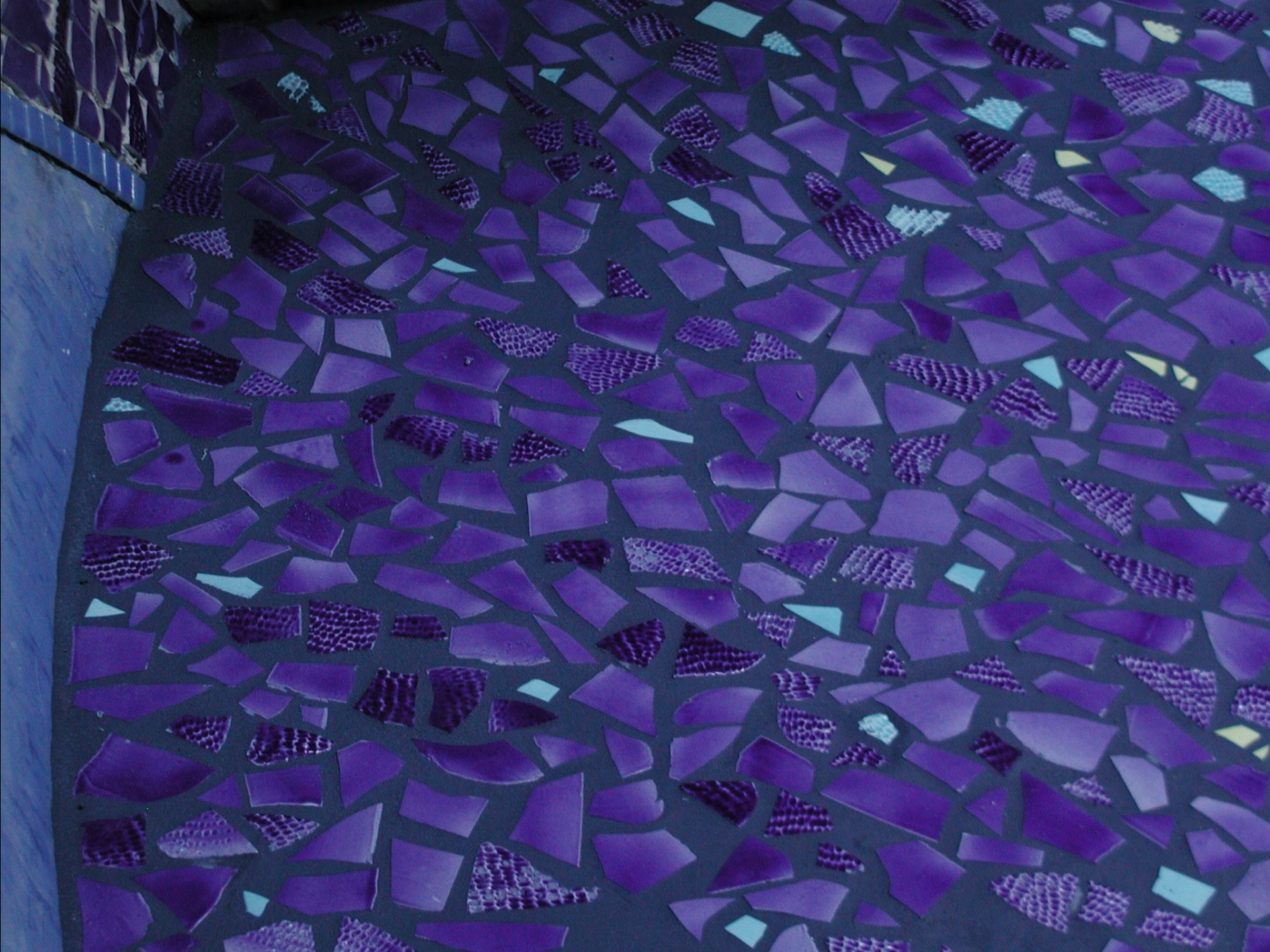



































































































































































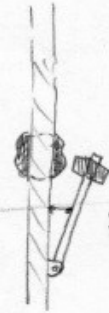
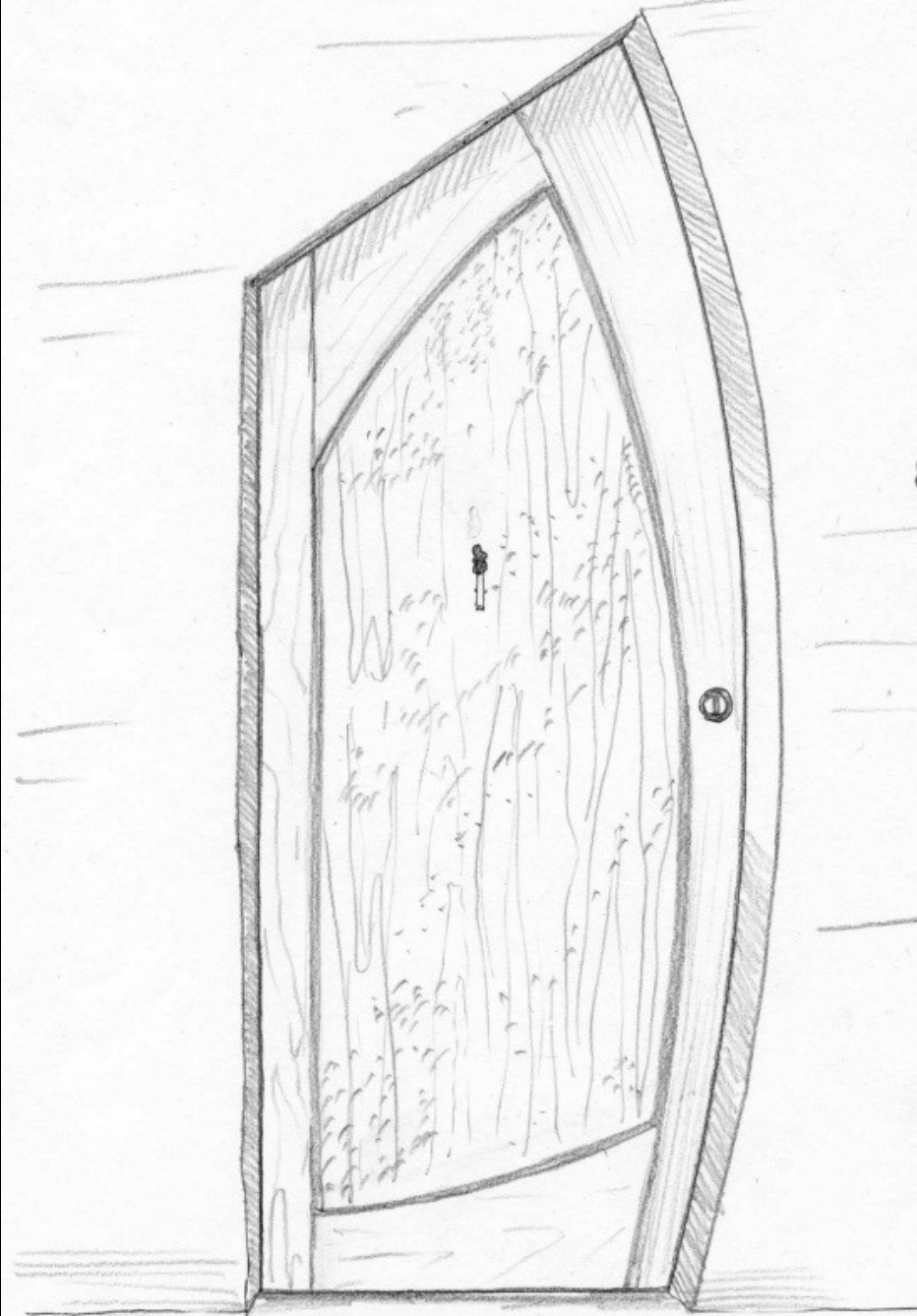

KNOCKER

OUTSIDE



# EXECUTIVE LIVING

## A well-rounded experience

Architect's round house shows off creativity, gives kids a stimulating environment



*Choosing a home, in general, is a very personal decision, even more so if you have a hand in designing it and building it. We spoke with three different area executives with three very different stories on how their family homes came to be.*

**BY LOU CORSARO**

**W**hen Matt Schluieb and his wife decided to move from California to Pittsburgh, it presented a unique opportunity for the architect.

Using a piece of property in Wexford, Schluieb, principal of his architectural firm, SCHLUEB architecture, could design the home from the ground up. Several thoughts went through Schluieb's head — it was a chance to get creative and build with an eye toward green principles. But one thing stood











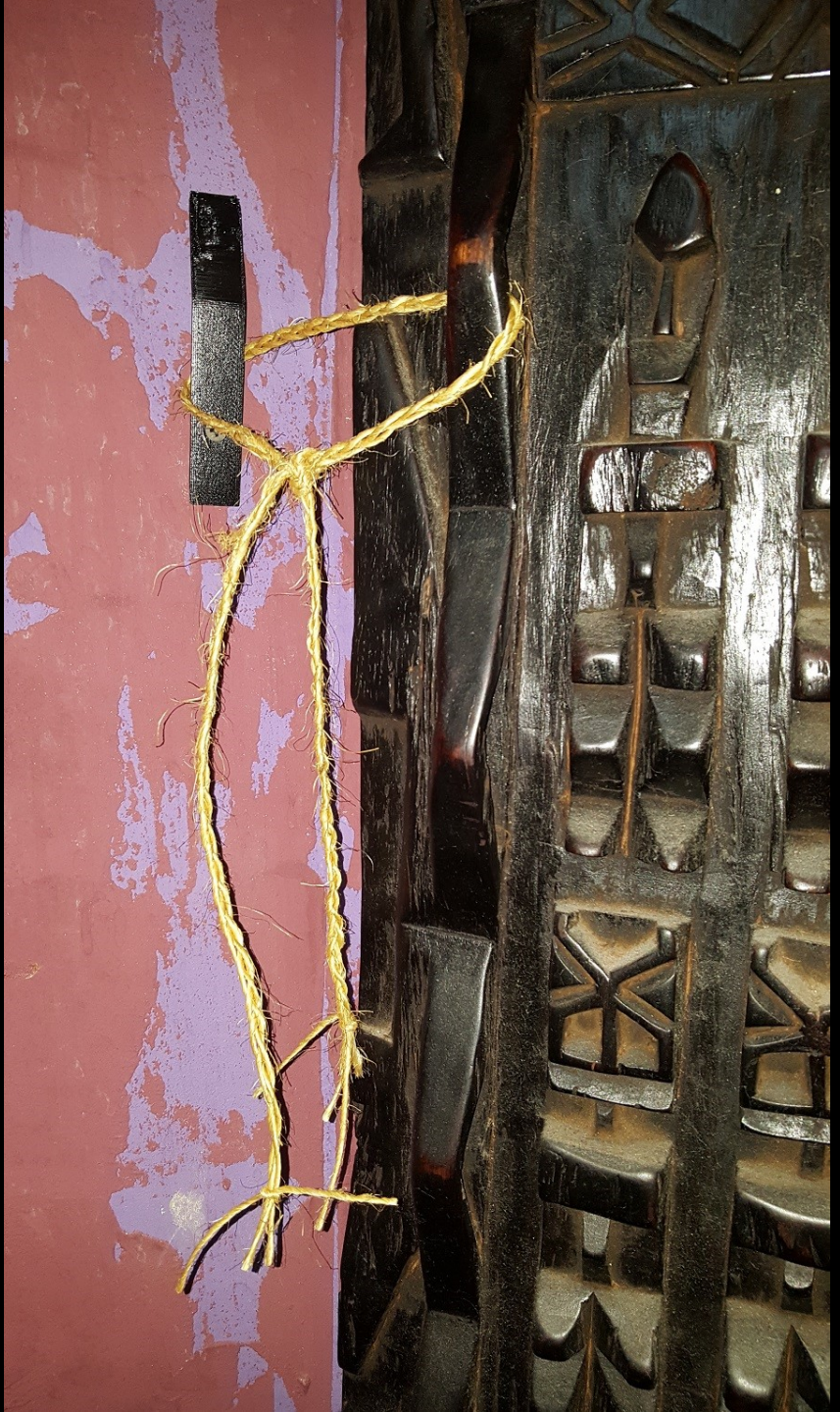



































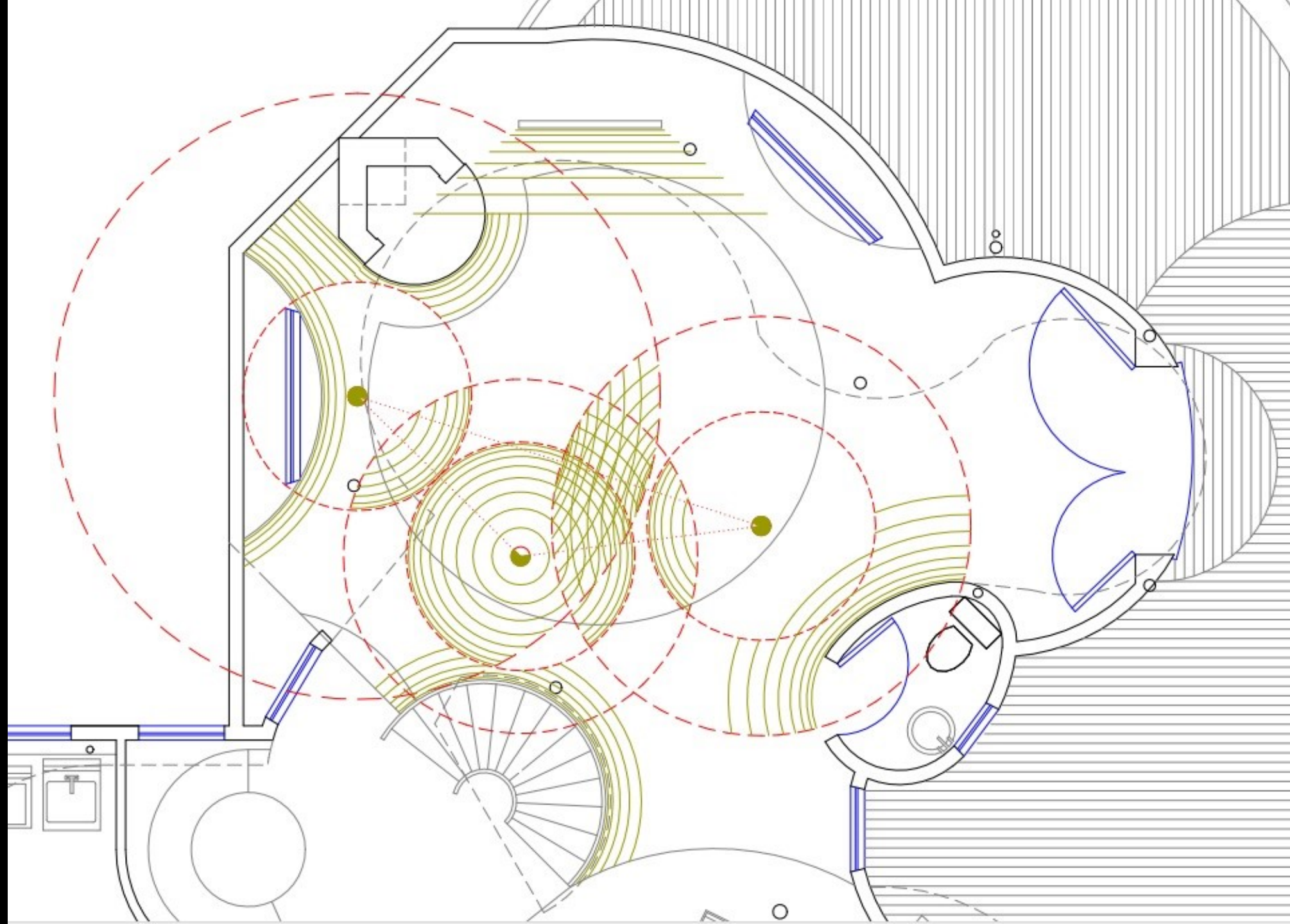





0:00 / 2:19

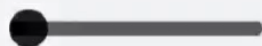















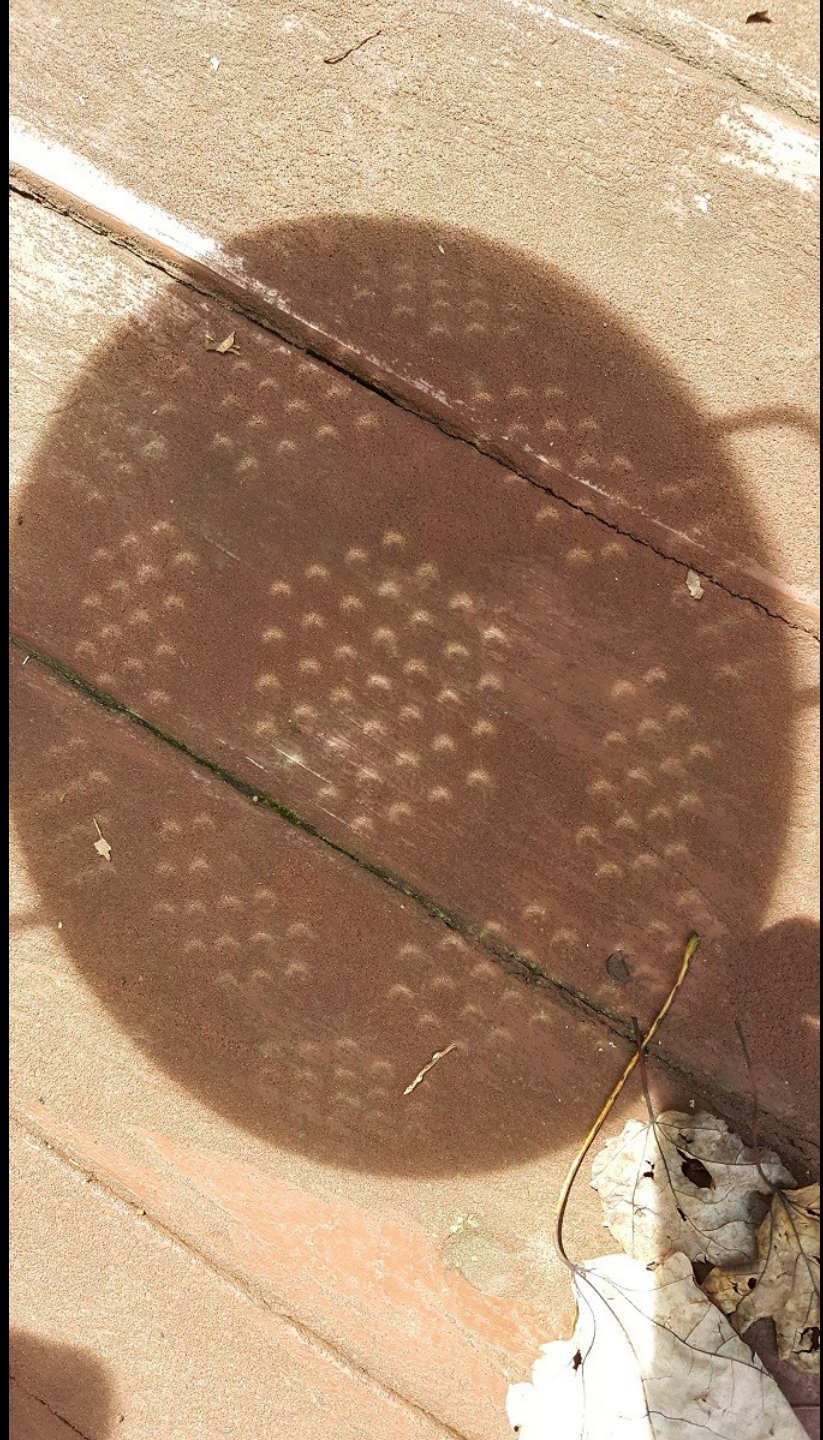





























THE MORE YOU CONNECT, THE LESS YOU CONNECT  
A reminder to 'Put People First' from

















































































**NOTE**

WOOD MEMBRANE AND ASPHALT QUILT TO EXTEND CONTINUOUSLY OVER ALL CONCRETE FLOOR AND SUBSURFACES. CONCRETE FLOOR BEAMS SHOULD BE LOW OTHER CONCRETE FLOOR SURFACES TO BE BUILT UP AS SHOWN BY 3/8" WOOD STRIPS LAID ON 1/4" MASTIC FIRST LAID ON OF BEAMS AND 1/4" STRIP OF MASTIC LAID ON TOP OF WOOD STRIPS UNDER WOOD MEMBRANE. STONE PAVEMENT LAID DIRECTLY OVER ASPHALT QUILT.

**NOTE**

*Intersections to be @ 10'*

*Concrete wall  
Lead and copper*

*Lead counter flashing*

*Copper special flashing compound  
under lead counter flashing*

*Curbs - ?*

*felt*

LEAD COUNTER FLASHING

STONE PAVING

*Red wood*

*Curbs  
2x4  
1/8" mastic  
Cellulose expansion joint*





# Relative Humidity

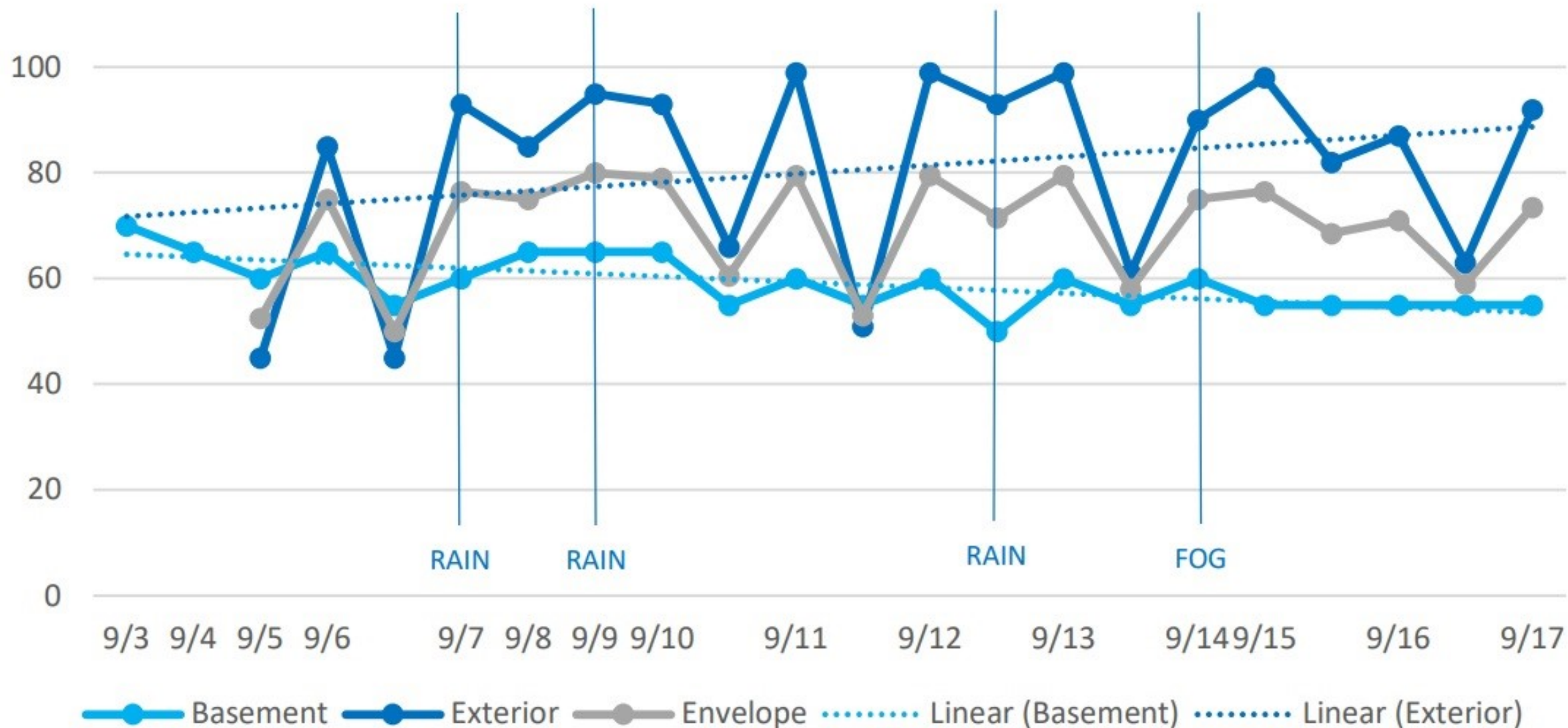



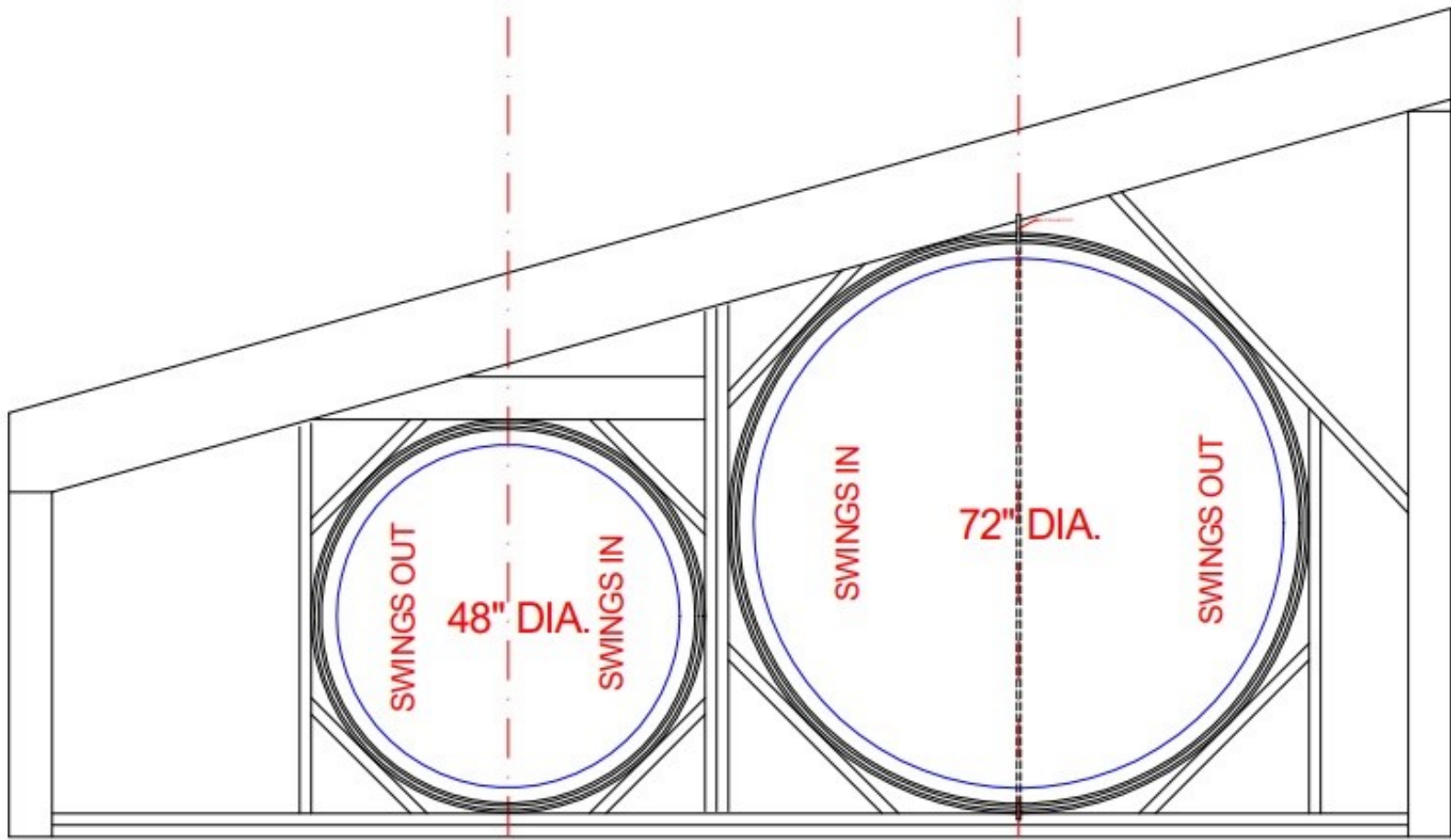

5' 5-1/4"

4' 2"

INTERIOR ELEVATION

2024.04.06



